

Please, read this manual before use!

Instruction



Gasoline generators

KS 12-1E ATSR

KS 12-1E 1/3 ATSR

Two-cylinder gasoline generators

KS 15-1E ATSR

KS 15-1E 1/3 ATSR

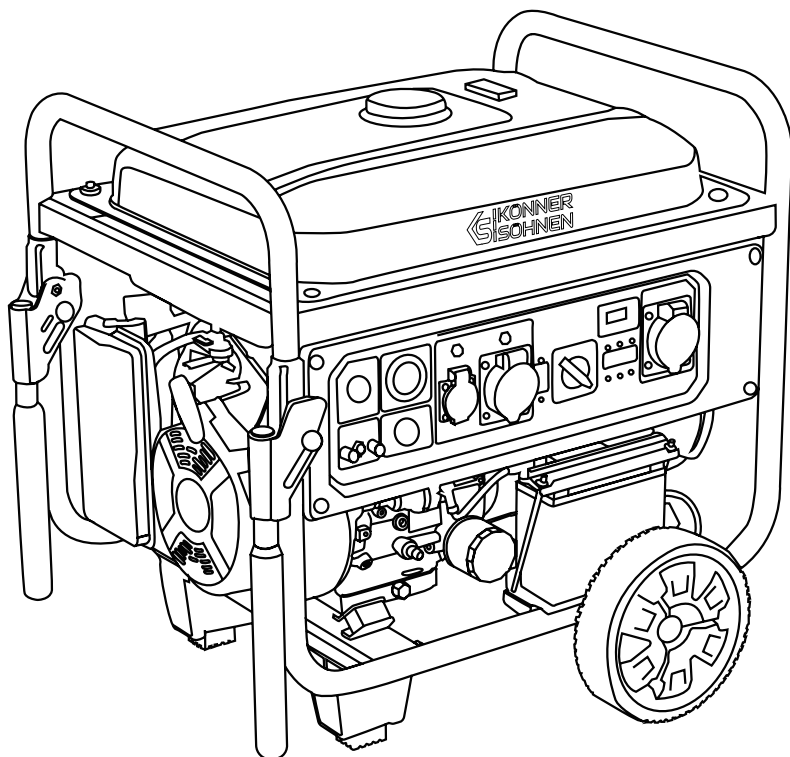



Thank you for choosing **Könnner & Söhnen®** products. This manual contains a brief description of safety, setup usage. More information can be found on the official importer's website in the support section: konner-sohnen.com/pages/instructions

You can also go to the support section and download the manual by scanning the QR code or on the website of the official importer of **Könnner & Söhnen®** at www.konner-sohnen.com



We care about the environment, therefore, we consider it expedient to save paper and leave in print a short description of the most important sections.



Be sure to read the full version of the manual before getting started!



The manufacturer of **Könnner & Söhnen®** products reserves the right to make changes that may not be reflected in this manual, namely:

- The manufacturer reserves the right to make changes in the product design, configuration and construction.
- The images and drawings in this manual are for reference only and may differ from the actual components and inscriptions on the products.

Contact information that you are free to use in case of any problems can be found at the end of this manual. All information in this user manual is up-to-date as of the time of publication. The current list of service centers can be found on the official importer's website at www.konner-sohnen.com



ATTENTION – DANGER!



Failure to follow the recommendations marked with this sign may lead to serious injury or death of the operator or third parties.



IMPORTANT!



Useful information while operating the machine.

SAFETY INFORMATION

1

Do not use the generator in rooms with poor ventilation or in conditions of excessive humidity. Do not place the generator in water or on moist soil. Do not expose the generator to rain, snow, as well as to direct sunlight for a long time. Place the generator on a flat, hard surface, away from flammable liquids/gases (at a minimum distance of 1 m). Install the generator at a distance of not less than 1 m from the front control panel and not less than 50 cm on each side, including the upper part of the generator. Keep unauthorized persons, children, and animals away from work area. Wear safety shoes and gloves.



ATTENTION – DANGER!



When using the generator, attention must be paid to the actual power consumption of the connected electrical consumers, including the power factor (cosφ) and the starting power, which for devices with motors can be several times higher than the rated power and must not exceed the maximum output of the generator.



ATTENTION – DANGER!



As exhaust gases contain poisonous carbon dioxide (CO₂) and carbon monoxide (CO) gases which are dangerous for life, it is strictly forbidden to install the generator in residential buildings, premises connected to residential buildings by a common ventilation system, other rooms from which exhaust gases may enter living premises.

**ATTENTION – DANGER!****The device generates electricity. Follow safety precautions to avoid electric shock.**

The generator produces electricity that may lead to an electric shock while neglecting compliance regulations. All connecting the generator to the network must be made by certified electrician in accordance with all electrical rules and regulations. Connect the generator to the protective ground before operation. Wires with damaged or spoiled insulation should be replaced. You should also replace worn, damaged or rusty contacts.

**IMPORTANT!****Using device for other purposes deprives the right for free warranty.****ATTENTION – DANGER!****Be careful. Do not operate the generator, if you are tired, under the influence of drugs or alcohol. Inattention may cause a serious injury.**

PRECAUTIONS WHEN WORKING WITH GASOLINE GENERATOR

1.2

Overheating of the generator due to prolonged operation and insufficient ventilation must be strictly avoided. Do not start the generator operation upon presence of electric load! Disconnect the load before you stop the engine. **Use only unleaded gasoline with an octane rating of 90–95 containing no more than 10% ethanol.** The use of kerosene or any other type of fuel is not allowed! Always follow the manufacturer's recommendations regarding the shelf life and storage of fuel. The fuel in the tank comes into contact with air, which can affect its quality. Over time, depending on the quality of the fuel, deposits may accumulate in the float chamber of the carburetor, which must be drained regularly to ensure the carburetor functions properly. If the generator is not used for an extended period of time, we recommend completely draining the gasoline from the carburetor and the tank via the drain screw on the carburetor to prevent the formation of deposits in the fuel system. Failure to follow these recommendations may lead to the damage of the carburetor. Cooling breaks of 30–60 minutes should be taken after each tank of fuel is used.

**ATTENTION – DANGER!****Fuel contaminates the land and groundwater. Do not allow the leaking gasoline from the tank!**

| *Safety symbols and description of inscriptions can be found in the full electronic version.*

MAIN OVERVIEW

2

**IMPORTANT!****Manufacturer reserves the right to make changes and/or improvements in design, components set and technical attributes without notice and without incurring obligation. The pictures in this manual are schematical and may not match the parameters of original product.**

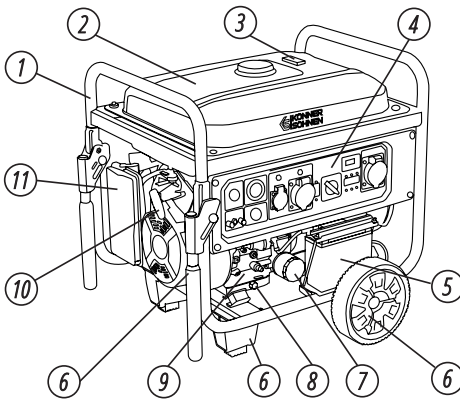

1. Reinforced steel frame
2. Fuel tank
3. Fuel level indicator
4. Control panel
5. 12 V battery
6. Transportation kit (wheels, support legs, handles)
7. Oil filter
8. Oil bleeder screw
9. Engine
10. Manual start for models KS 12-1E ATSR, KS 12-1E 1/3 ATSR
11. Filter

FEATURES USING AS A THREE-PHASE GENERATOR:

3

The three-phase diesel generator should have the power distributed to all three phases, and the power should be distributed equally. The power at each of the three phases must not exceed 1/3 of the total power of the generator. The balance between phases tolerance should not exceed 20%. If only 1 phase or 2 phases are loaded, the generator will fail. The total power and total current at all three phases must not exceed the normal load and amperage of the generator.

COMPONENTS OF SET

4

Generator, packaging, owner's manual, warranty card, accessories:

1. 2× start keys.
2. 1× spark plug key.
3. Transportation kit (wheels, support legs, handles, semi-axle).
4. Set of plugs for corresponding outlets of each model.



DIGITAL DISPLAY

5

The selection of indicators is cyclic.

- A. This mode displays the generator output voltage in volts.
- B. This mode displays the generator output frequency in Hertz.
- C. This mode displays the generator operation time from start-up in minutes.

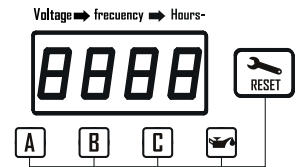

Low oil level indicator.

DURING GENERATOR OPERATION:

- You may use the generator, if the voltage meter displays the value $230\text{ V} \pm 10\%$ (50Ng).
- Watch the voltage meter and in case of excessive indices values, stop the generator operation.
- Connection to continuous voltage socket 12V is used for accumulator recharge only. Upon accumulator unit recharge, it is mandatory to verify the polarity correctness (+ to +, - to -). The current must not exceed 8 A.
- Wires of charging device are to be at first connected to the accumulator unit and only then – to the generator itself. All “generator to network” connections are to be carried out by a certified electrician. Any mistakes may result in serious equipment damage.
- It is forbidden to use 12V voltage simultaneously with 230V.

The description and layout of control panels for various models can be found in the full electronic version of the manual.

Model	KS 12-1E ATSR	KS 12-1E 1/3 ATSR	KS 15-1E ATSR	KS 15-1E 1/3 ATSR
Voltage	230V	230V	400V	230V
Maximum power	9,2 kW	8,2 kW	11,5 kVA	12,5 kW
Rated power	9,0 kW	8,0 kW	11,25 kVA	12,0 kW
Frequency	50 Hz	50 Hz		50 Hz
Current max	40A	35A	17A	53A
Outlets	1×CEE 230V 63A 1×CEE 230V 32A 2×Schuko 230V 16A	1×CEE 400V 32A 1×CEE 230V 32A 2×Schuko 230V 16A	1×CEE 230V 63A 1×CEE 230V 32A 2×Schuko 230V 16A	1×CEE 400V 32A 1×CEE 230V 63A
Fuel tank volume	55 l	55 l	55 l	55 l
LED display	voltage, frequency, working hours, oil level			
Noise level Lpa (7m)/Lwa	74/97 dB	74/97 dB	73/96 dB	73/96 dB
Power output 12V/8.3A	+	+	+	+
Engine model	KS 650	KS 650	KS 650	KS 650
Engine type	gasoline powered one-cylinder, four-stroke air-cooled		gasoline powered two-cylinder, four-stroke air-cooled	
Engine power	18,5 hp/13,5 kW	18,5 hp/13,5 kW	22,0 hp/16,0 kW	22,0 hp/16,0 kW
Generator emergency stop button	+	+	+	+
Crankcase volume	1,4 l	1,4 l	1,5 l	1,5 l
Engine volume	625 cm ³	625 cm ³	750 cm ³	750 cm ³
Power output controller	AVR	AVR	AVR	AVR
Engine start	manual/electric	manual/electric	electric	electric
Power factor	cos φ 1 (230V)	cos φ 1 (230V)/ cos φ 0,8 (400V)	cos φ 1 (230V)	cos φ 1 (230V)/ cos φ 0,8 (400V)
Battery	21 Ah	21 Ah	36 Ah	36 Ah
Net dimensions (L×W×H)	790×705×680 mm		780×705×680 mm	
Gross dimensions (L×W×H)	800×715×780 mm		807×715×905 mm	
Net weight	120 kg	120 kg	155 kg	155 kg
Gross weight	136 kg	136 kg	170 kg	170 kg
Protection class	IP23M	IP23M	IP23M	IP23M
Altitude (MAX)	1000 m	1000 m	1000 m	1000 m
Relative humidity	<95%	<95%	<95%	<95%
Acceptable deviation of a current is 5%				

The optimal operating conditions are ambient temperature of 17-25°C, barometric pressure of 0.1 MPa (760 mm Hg), and relative humidity of 50-60%. Under these environmental conditions, the generator can provide maximum performance in terms of the declared specifications.

In the event of deviations from these environmental indicators, the generator performance may vary.

Please note that continuous loads exceeding 80% of the generator's rated power are not recommended in order to extend its service life.

The generator is supplied without fuel. Before the operation please fill the fuel. Guidelines for filling are below. Generators are supplied without motor oil. The generator casing may contain residues of oil after tests conducted during production.

Before starting to use the generator, be sure to pour oil. Recommendations on oil and it's filling process are below. Follow maintenance recommendations during the first month or twenty hours (whichever occurs first) contained in the "Maintenance" section.

For commissioning models with elektrostart please charge the battery. Please use additional battery charger (not included) to charge the battery or let the generator work at least one hour at 50% load at the first start.

GROUND TERMINAL

The ground terminal forms a ground line to prevent electric shock.



IMPORTANT!



Before starting the generator, connect the ground wire to the ground terminal.

This material is for informational purposes only and does not constitute a manual for installing the equipment or connecting it to the mains, but we strongly recommend that you read the instructions below. Equipment connection must always be carried out by a certified electrician responsible for the installation and electrical connection of the equipment according to local laws and regulations. The manufacturer assumes no liability for improper connection of the equipment or for any material or physical damage that may result from improper installation, connection or operation of the equipment.

IN THE FIRST 20 OPERATING HOURS OF THE GENERATOR, THE FOLLOWING REQUIREMENTS SHOULD BE MET:

1. It is recommended not to load the generator above 50% for extended periods during the first 20 operating hours, to allow the engine to run in properly.
2. After the first 20 operating hours, be sure to change the oil. The first engine oil change is mandatory after the first 20 to 25 operating hours to remove metallic wear particles from the engine.
3. Check and clean the air filter, fuel filter and spark plug.

1. Check the fuel level. **Unleaded gasoline with an octane rating of 90–95 containing no more than 10% ethanol.**
2. Check the oil level.
3. If the generator has not been used for a long time, try charging the battery with the battery charger (not included).

CONNECTION OF GENERATOR WITH BUILT-IN ATS

Generators are equipped with a universal ATS output for connecting an Automatic Transfer Switch unit.

The ATS system allows the generator to be automatically stopped in the event of power outage and then automatically started when the power supply is restored without user intervention.

| Connection diagrams for generators with built-in ATS can be found in the full electronic version of the manual.



ATTENTION - DANGER!



Risk of electric shock! Network connection should only be carried out by a qualified technician.

**IMPORTANT!**

Do not connect devices before starting the engine. In power supply mode within range from nominal till maximum power, the generator may operate not more than 30 minutes.

Before connecting any devices to the generator, make sure that they are in good working order. If the connected device suddenly stopped or failed, immediately de-energize the device using the emergency switch, disconnect the device and check it out.

**IMPORTANT!**

Do not let the simultaneous connection of two or more devices. Devices are to be connected in turns, according to its maximum allowed power. Do not connect the consumers in first 1-2 minutes after the generator start.

GASOLINE GENERATOR ENGINE START

1. Fuel supply valve to be set in "OPEN" position.
2. Upon electric start – turn the key to "ON" position and hold it in "START" position till the engine starts. Immediately release the key after the engine starts.
3. Upon manual start – set the engine switch to "ON" position. Start slowly pulling the starter till you feel slight resistance. By an abrupt movement pull the starter to full cord length. The engine will now start.

For models with elektrostart check whether battery is charged, if necessary, charge it using an external charger (not included) or run the generator with manual start and let it run without load for recharging.

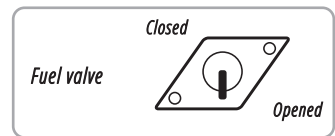

GENERATOR LAUNCH IN ATS MODE

1. For the generator with built-in ATS input, connect the control wire to the input on the front panel of the generator. Connect the power cable to the power outlet of the generator and the ATS unit.
2. Set the ATS switch to "AUTO" position.
3. Set the starting key to "ON" position at the generator panel.

In order to run the generator without ATS mode – do not set the ATS switch to "AUTO" mode.



ENGINE STOP

**IMPORTANT!**

Do not stop the generator, if there are any devices connected. This may result in generator or your appliances breakdown!

1. Stop all power consuming devices connected to the generator, by setting the emergency switch to "OFF"
2. Turn the fuel valve to "CLOSED" position.
3. Please let the generator to work for 1-2 minutes without load to cool the alternator.
4. Set the engine switch/ turn the key to "OFF" position.

MAINTENANCE

This manual compliance! You can find a list of service center addresses on the website of exclusive importer:
www.konner-sohnen.com

TECHNICAL MAINTENANCE WORKS

Node	Service type	Every start	First month or 20 hours	Each 3 months or after 50 working hrs	Each 6 months or after 100 working hrs	Each year or after 300 working hrs
Motor oil	Check the level	✔				
	Replace		✔	✔		
Air filter (for model KS 12-1E ATSR, KS 12-1E 1/3 ATSR)	Check	✔				
	Clean out			✔		
Air filter (for model KS 15-1E ATSR, KS 15-1E 1/3 ATSR)	Check	✔				
	Replace					✔
Ölfilter	Replace				✔	
Kraftstofftank	Check the level	✔				
	Clean out					✔
Kraftstofffilter	Check/Clean out				✔	

RECOMMENDED OILS

15

Use oils designed for four-stroke cycle vehicle engines SAE 10W-30, SAE 10W-40. Motor oils with other viscosity levels, may be used only if the average air temperature in your region does not exceed the limits of the temperature range, specified in the table.

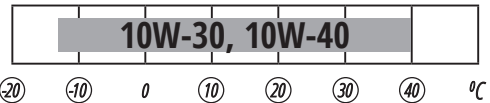

Upon oil level decrease it is necessary to add the required quantity in order to provide the correct generator operation. It is necessary to check the oil levels according to technical maintenance schedule. The detailed description of oil filling and draining can be found in the full version of the manual.



PLEASE NOTE!



It is better to drain oil while the engine is still hot after operation to ensure quick and complete oil draining.

AIR FILTER TECHNICAL MAINTENANCE

16

The air filter should be checked for contamination from time to time. Regular maintenance of the air filter is necessary to maintain sufficient air flow in the carburetor and normal carburetion, which in turn ensures fuel economy.

Air filter cleaning is to be performed each 50 hours of the generator operation (every 10 hours in unusually dusty conditions).

CLEANING THE FILTER:

1. Open the clips on the upper cap of the air filter.
2. Remove the sponge filtering element.
3. Remove all dirt deposits inside the hollow case of the air filter.

4. Clean the filter element (for models KS 12-1E ATSR, KS 12-1E 1/3 ATSR, replace the filter element (for models KS 15-1E ATSR, KS 15-1E 1/3 ATSR).
5. Dry the sponge filter.
6. Dry filtering element is to be moistened by machine oil and excess oil is to be squeezed out.
7. Replace the filter element.
8. Close the air filter cover.



Air filter for models
KS 12-1E ATSR,
KS 12-1E 1/3 ATSR



Air filter for models
KS 15-1E ATSR,
KS 15-1E 1/3 ATSR

OIL FILTER MAINTENANCE

17

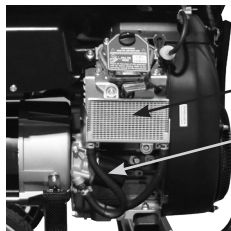

Oil filter for models KS 15-1E ATSR, KS 15-1E 1/3 ATSR

Oil cooler

Oil filter

For generator models KS 12-1E ATSR, KS 12-1E 1/3 ATSR, the oil filter is located on the front of the generator below the control panel.

SPARK PLUGS TECHNICAL MAINTENANCE

18

Spark plug has to be intact, without soot deposits and to have a correct gap.

SPARK PLUG VERIFICATION:

1. Remove the cap from the spark plug.
2. Remove the spark plug by means of a corresponding spanner.
3. Examine the spark plug. If it is shattered – it is necessary to replace it. Recommended replacement spark plugs – F7TC.
4. Measure the gap. It has to be within range 0,7 - 1,0 mm.
5. In case of repeated use, the spark plug has to be cleaned by means of a metal brush. After that – set the correct gap.
6. Place the spark plug in its place by means of a spark plug spanner.
7. Replace the spark plug cap.

BATTERY USE

19

The generator battery is not subject to service. If the generator is not used for a long time, the battery may fail. To prolong battery life it is recommended to do battery charging with an external device (not included) every three months. Battery warranted - three months from the date of purchase of the generator.

STORAGE

20

Storage room has to be dry and free from dust deposits. Storage room also has to be locked away from children and animals. It is recommended to store and use the generator at temperature of -20°C to +40°C. Avoid direct sunlight, rain on the generator.



NOTE!



We recommend that you keep the generator in good working order at all times. Any malfunctions in the generator must be repaired before placing the generator in storage.

Information on long-term storage and transportation can be found in the full version of the manual.

Potential faults and troubleshooting methods, as well as average device capacities can be found in the full version of the manual.

BATTERY AND GENERATOR DISPOSAL

21

To prevent environment damage generator and battery should be separated from ordinary waste. Please recycle them in the safest way, passing it to special place for disposal.

WARRANTY SERVICE TERMS

22

The international manufacturer warranty is 2 year or 1000 hours (whichever comes first). The warranty period starts from the date of purchase. Within the warranty period, if the product fails because of defects in the production process, it will be exchanged on the same product or repaired.

The warranty card should be kept throughout the warranty period. In case of warranty card loss, a second one will not be provided. The customer must provide the warranty card and buyer`s check during request for repair or exchange. Otherwise, the warranty service will not be provided.

Provide clean product to the service center. Parts, that must be replaced, are the property of the service center.



EC Declaration of Conformity

Nr. 271

The following products have been tested by us with the listed standards and found in compliance with the European Community Machinery Directive 2006/42/EC, Electromagnetic compatibility Directive (EMC) 2014/30/EC, Noise Directive 2000/14/EC.

Manufacturer: DIMAX INTERNATIONAL GmbH
Address: Flinger Broich 203 -FortunaPark- 40235 Duesseldorf, Germany
Product: Gasoline generators "Könnner & Söhnen"
Type / Model: KS 12-1E ATSR, KS 12-1E 1/3 ATSR,
KS 15-1E ATSR, KS 15-1E 1/3 ATSR,
Applied EC Directives: 2006/42/EC Machinery Directive
2014/30/EC Electromagnetic compatibility Directive (EMC)
2000/14/EC Noise Directive
(EU) 2016/1628 Non-Road mobile machinery emissions
Applied Standards: EN ISO 3744:2010
EN ISO 8528-10:2022
EN 55012:2007/A1:2009
EN 61000-6-1:2007
EN 8528-13:2016

Gasoline engine KS 650, KS 780 correspond to European Emission Standard Euro V (STAGE V).
This is confirmed by EU TYPE-APPROVAL CERTIFICATE.

Technical service responsible for carrying out the test -IDIADA.

Date of issue 16/03/2018

Guaranteed noise level:

95 dB(A) for KS 15-1E 1/3 ATSR, KS 15-1 E ATSR

97 dB(A) for KS 12-1E ATSR, KS 12-1E 1/3 ATSR



19

Issued Date:
Place of issue:
Director:

2026-05-01
Duesseldorf
Fomin P.

DIMAX
International GmbH
Flinger Broich 203 40235 Düsseldorf
USt-ID DE296177274
koenner-soehnen.com

P. Fomin

We DIMAX INTERNATIONAL GmbH hereby declare that specified above conforms covering European Parliament and Council Directives, 2006/42/EC of 17 May 2006 Machinery Directive, Electromagnetic compatibility Directive (EMC) 2014/30/EC of 26 February 2014, Noise Directive 2000/14/EC of 8 May 2000. The CE mark above can be used under the responsibility of manufacturer. After completion of an EC declaration of Conformity and compliance with all relevant EC directives.

CONTACTS

Deutschland:

Hergestellt unter Lizenz und Kontrolle der DIMAX International GmbH.

Importeur und Vertreter in Deutschland:
DIMAX International GmbH, Flinger Broich 203,
40235 Düsseldorf, Deutschland. Produziert in VRC.
amazon@dimaxgroup.com
www.konner-sohnen.com

European Union:

Manufactured under license and control of DIMAX International GmbH, Flinger Broich 203, 40235 Duesseldorf, Germany.

Importer and representative in Netherlands DIMAX International Poland Ltd, Południowa 8 st,
05-830 Stara Wieś, Poland. Assembled in PRC.
amazon@dimaxgroup.com
www.konner-sohnen.com

The United Kingdom:

Innovation Trade Ltd., 5th Floor, 167-169 Great Portland Street, London, W1W 5PF, sales.uk@dimaxgroup.com

Technical support

support.uk@dimaxgroup.de
www.konner-sohnen.uk

France:

Fabriqué sous licence et contrôle de DIMAX International GmbH, Flinger Broich 203, 40235 Düsseldorf, Allemagne.

Importateur et représentant en France et en Belgique DIMAX International Poland Ltd, Południowa 8 st,
05-830 Stara Wieś, Pologne. Assemblé en RPC.
amazon@dimaxgroup.com
www.konner-sohnen.fr

España:

Fabricado bajo licencia y control de DIMAX International GmbH, Flinger Broich 203, 40235 Düsseldorf, Alemania.

Importador y representante en España de DIMAX International Poland Ltd, Południowa 8 st,
05-830 Stara Wieś, Polonia.
Ensamblado en la República Popular China.
amazon@dimaxgroup.com
www.konner-sohnen.es

Polska:

Wyprodukowano na licencji i pod kontrolą DIMAX International GmbH, Flinger Broich 203, 40235 Duesseldorf, Niemcy.

Importer i przedstawiciel w Polsce:
DIMAX International Poland Sp.z o. o. ul. Południowa 8,
05-830 Stara Wieś, Polska. Zmontowany w CRL.
amazon@dimaxgroup.com
www.konner-sohnen.pl

Україна:

Виготовлено за ліцензією та під контролем DIMAX International GmbH, Flinger Broich 203, 40235 Дюссельдорф, Німеччина.

Імпортер та представник в Україні:
ТОВ "ТЕХНО ТРЕЙД КС" вул. Електротехнічна 47,
02225, м. Київ, Україна. Змонтовано в КНР
www.konner-sohnen.com.ua

